

## WFI // with Mini-Fit plug // -40...125 °C



WFI

### Your advantages

Type	WFI
	<ul style="list-style-type: none"> <li>• Cost-effective electrical connection through Mini-Fit connector</li> <li>• Efficient control due to very short response times</li> <li>• Application-specific installation lengths and screw-in threads possible</li> <li>• High reliability due to special internal construction</li> <li>• Measured values reproducible for years due to very low long-term drift</li> </ul>

Technical data	
Type	Temperature sensor with Mini-Fit plug
Measuring range	-40...125 °C
Measuring medium	Water and aqueous liquids, non-aggressive gases
Immersion tube length	15 mm or 19.5 mm
Immersion tube diameter	3.2 mm
Process connection	G $\frac{1}{8}$
Nominal pressure	PN 25
Medium temperature	-40...125 °C
Ambient temperature	-40...105 °C
Storage temperature	-25...70 °C
Degree of protection according to EN 60529	IP30

Electrical data	
Measuring element	1 x Pt1000 / 2-wire 1 x NTC 5k
Measuring insert	Not interchangeable
Accuracy	Class B / $\pm(0.30 \text{ K} + 0.005 \times  t )$ NTC 5k $\pm 0.2^\circ\text{C}$ in the range 0... +70°C (B25/85= 3977 K $\pm 0.3\%$ )
Electrical connection	Mini-Fit plug, 2-pole

## WFI

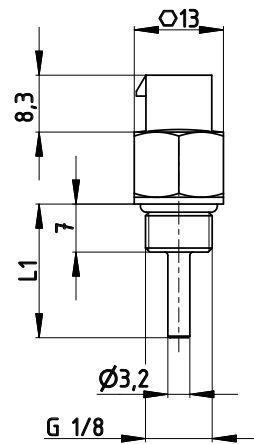

Materials	
In contact with media	
Process connection	Edelstahl 1.4571 / 1.4404
Protection tube	Edelstahl 1.4571 / 1.4404
Seal	EPDM; WRAS-, KTW-, W270 approval

Order code							
<b>Type</b>							
Resistance thermometer	SME8						
<b>Diameter</b>							
3.2 mm		32					
<b>Material</b>							
Stainless steel 1.4571 / 1.4404			0				
<b>Sensor element</b>							
1 x Pt1000 2-wire / Class B				P12			
1 x NTC 5k				N01			
<b>Tauchrohrlänge L1</b>							
15 mm					015		
19.5 mm					019		
<b>Electrical connection</b>							
Mini-Fit, 2-pole						X0	
<b>Process connection d1*</b>							
G $\frac{1}{8}$							M
<b>Example order number</b>	<b>SME8</b>	<b>32</b>	<b>0</b>	<b>P12</b>	<b>015</b>	<b>X0</b>	<b>M</b>

\* Other specifications available on request

