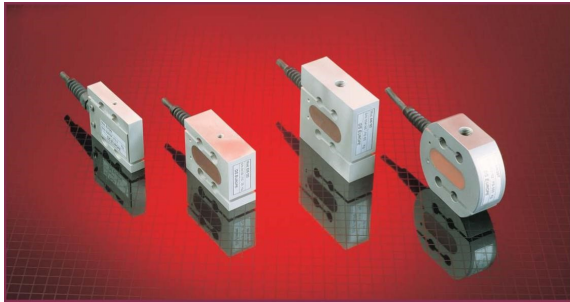

GENERAL SHORT FORM CATALOG

SERIES 500QD-QDT LOAD CELLS

**Measuring ranges** (tension and compression):

514QD: 0 ÷ 2-3 Kg
535QD: 0 ÷ 6-12-25 Kg
546QD (aluminium): 0 ÷ 60-110 Kg
546QDT: 0 ÷ 220-330-550 Kg - 1-2 Ton
560QDT: 0 ÷ 350-500-1000-2000-3000-4000-5000 Kg

Output available:

Non-amplified: mV/V
Analog: 0-10 V; 4-20 mA (not for 560QDT)
Digital: RS485 (Modbus protocol), CANopen

SERIES BC3xx LOAD CELLS

Measuring ranges:

BC301 (tension and compression): 0 ÷ ±3-6-12-20-30-60 (Al)-100-150 (Ss) Kg
BC302 (compression): 0 ÷ 3-6-12-20-30 (Al) -60-100 (Ss) Kg
BC303 (compression): 0 ÷ 150-350-500 (Ss) Kg
BC304 (compression): 0 ÷ 500-1000-2000 Kg
BC304K1500 (compression): 0 ÷ 15 kN
BC305 (tension and compression): 0 ÷ ±100 (Al) -500-1000 Kg

Available output:

Non-amplified: mV/V

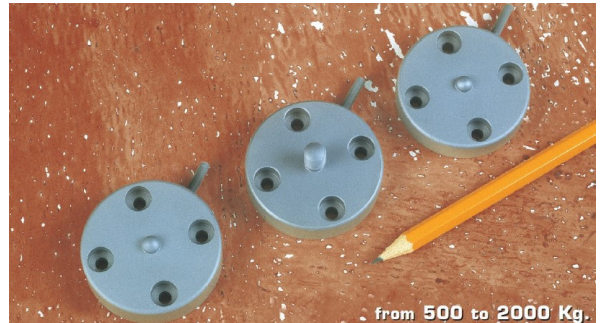

SERIES AP7000 LOAD CELLS

**Measuring ranges:**

AP7001S: 0 ÷ 250-500 Kg
AP7001: 0 ÷ 1 Ton
AP7003: 0 ÷ 3 Ton
AP7005: 0 ÷ 5 Ton
AP7010: 0 ÷ 10 Ton
AP7025: 0 ÷ 25 Ton
AP7050: 0 ÷ 50 Ton
AP7100: 0 ÷ 100 Ton

Available output:

Non-amplified: mV/V (from 250 Kg to 5 Ton FS)
Analog: 0-5 V; 0-10 V; 4-20 mA
Digital: RS485 (Modbus protocol); CANopen

SERIES LD-LT LOAD CELLS

Measuring ranges:

LD1: 0 ÷ 50-100-200-500-1000 Kg
LD5: 0 ÷ 1-2-5 Ton
LD10: 0 ÷ 5-10 Ton
LD100: 0 ÷ 20-50-100 Ton

LT05: 0 ÷ ±50; ±100; ±200; ±500 Kg
LT1: 0 ÷ ±200; ± 500; ± 1000 Kg
LT5: 0 ÷ ±1; ±2; ±3; ±5; ±6,5 Ton
LT50: 0 ÷ ±5; ±10; ±20; ±30; ±50 Ton

Available output:

Non-amplified: mV/V
Analog: 0-5 V; 0-10 V; 4-20 mA
Digital: RS485; Modbus; CANopen

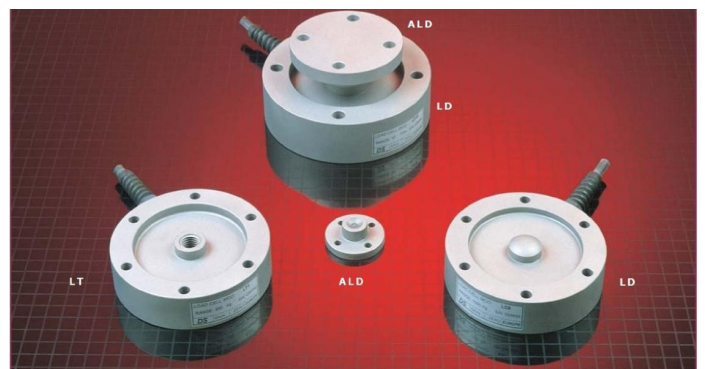

SERIES HC/RC LOAD CELLS

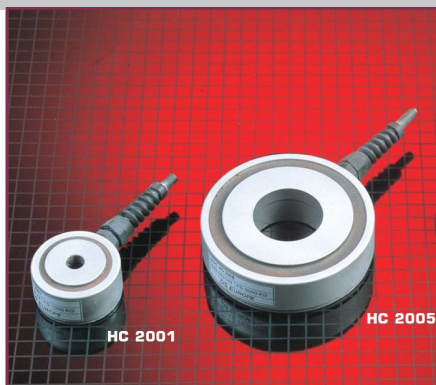

Measuring ranges:

HC2001 (Al): 0 ÷ (20)-50-100-200-300 Kg

HC2001 (Fe): 0 ÷ 500-1000 Kg

HC2002 (Fe): 0 ÷ 2 Ton

RC5: 0 ÷ 5 Ton

RC10: 0 ÷ 10-15 Ton

RC30: 0 ÷ 30 Ton

HC7050 (Fe): 0 ÷ 50 Ton

HC7100 (Fe): 0 ÷ 100 Ton

Available output:

Non-amplified: mV/V (HC models)

SERIES MD LOAD CELLS

Measuring ranges:

MD4000: 0 ÷ ±1; ±3; ±5; ±10; ±20; ±50; ±100 Ton

MD5000: 0 ÷ ±1; ±3; ±5; ±10; ±15; ±25; ±40; ±60 Ton

Available output:

Non-amplified: mV/V

Analog: 0-5 V; 0-10 V; 4-20 mA

Digital: RS485 (Modbus protocol); CANopen



SERIES PT LOAD CELLS



Measuring ranges:

PT500: 0 ÷ 100-200-500-1000 Kg

Available output:

Non-amplified: mV/V

Analog: 0-5 V; 0-10 V;

Digital: RS485 (Modbus protocol); CANopen

SERIES ES270 INCLINOMETER/ACCELEROMETER

Measuring ranges:

Accelerometer: 0 ÷ ±1700 mg

Inclinometer: 0 ÷ ±90°

Available output:

Analog: 0-5 V

Digital: RS485 (Modbus protocol); CANopen



MULTIROPE SENSOR MRL - MRB HL



Measuring ranges:

MRL100: 0 ÷ 4000 Kg

MRL150: 0 ÷ 4000 Kg

MRL200: 0 ÷ 2000 Kg

MRB HL: 0 ÷ 7.300-11.000-25.000 Kg

Available output:

Non-amplified: mV/V

Digital: CANopen

STRAIN LINK 942

Measuring ranges: $\pm 500 \mu\epsilon$

Available output:

Non-amplified: mV/V

Digital: CANopen (DBCAN version)



UNDERFLOOR SENSOR TSP

Measuring range: 0 ÷ 800 Kg

Available output:

Non-amplified: mV/V

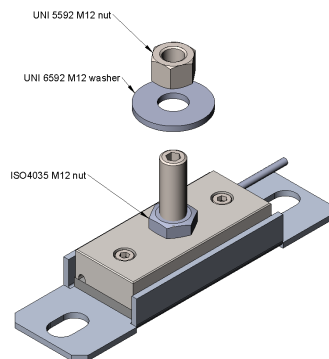

LOAD WEIGHING DEVICE 699Plus

Analog output: +5 V; +10 V; 4-20 mA

Digital output: RS485; CANopen

AD converter resolution: up to 20 bit

Electrical supply: +24 Vcc

Functions available: easy calibration procedure; towed chain compensation; relay block function when cabin moves and relay testing procedure and other diagnostic functions.



ROPES TENSIONING EQUALIZATION SYSTEM



Number of ropes: from 1 to 12

Type of ropes: metal ropes or plastic coated ropes

Ropes diameter: 6,5 mm or 8,1 mm

Digital output: USB or Bluetooth

Functions available: display of individual tensions identified on the individual ropes; indication of the total weight; defining a tolerance band on the average tensioning value; display of up-to-date real time statistical indicators

DISPLACEMENT AND LEVEL SENSOR PCS III - PCR III**Measuring ranges:**

PCS III: from 0 to 100 mm, up to 3000 mm (in +50 mm steps)

PCR III: from 0 to 100 mm, up to 3000 mm (in +50 mm steps)

Output available:*Analog:* 0-10 V or 10-0 V (voltage); 4-20 mA or 0-20 mA (current)*Digital:* RS485 (Modbus protocol) as standard; CANopen**SERIES PITAGORA****Input:** from 0 to ± 80 mV; +5 V; +10 V; 4-20 mA; 0-20 mA; Start Stop**Sample rate:** max 3,8 kHz/channel**Resolution:** max 24 bit**Analog output:** +5 V; +10 V; 0-20 mA; 4-20 mA**Digital output:** RS485; CANopen; USB**Available functions:** gross, net, tare, piece counting, positive or negative peak memory, hold, digital filtering, sum of up to 8 transducers signal**SERIES AN401****Input:** from 0 to ± 80 mV; +5 V; +10 V; 4-20 mA; 0-20 mA; Start Stop**Sample rate:** max 3,8 kHz/channel**Resolution:** max 24 bit**Analog output:** +5 V; +10 V; 0-20 mA; 4-20 mA**Digital output:** RS485; CANopen; USB**Available functions:** gross, net, piece counting, positive or negative peak memory, hold**SERIES AN601****Input:** from 0 to +80 mV**Sample rate:** from 7,5 Hz to 3840 kHz**Resolution:** 24 bit**Available functions:** calibration with displaying of measure in engineering units; zeroing-hold-peak memory

Via Imperia, 28—20142 Milano (ITALY)

Phone: +39 02 89 101 42

Fax: + 39 02 89 158658

<http://www.s2tech.it/> E-mail: info@s2tech.it

SKYPE: commerciale.s2tech



ISO 9001:2015 - Cert. n.6687