

Operating Instructions

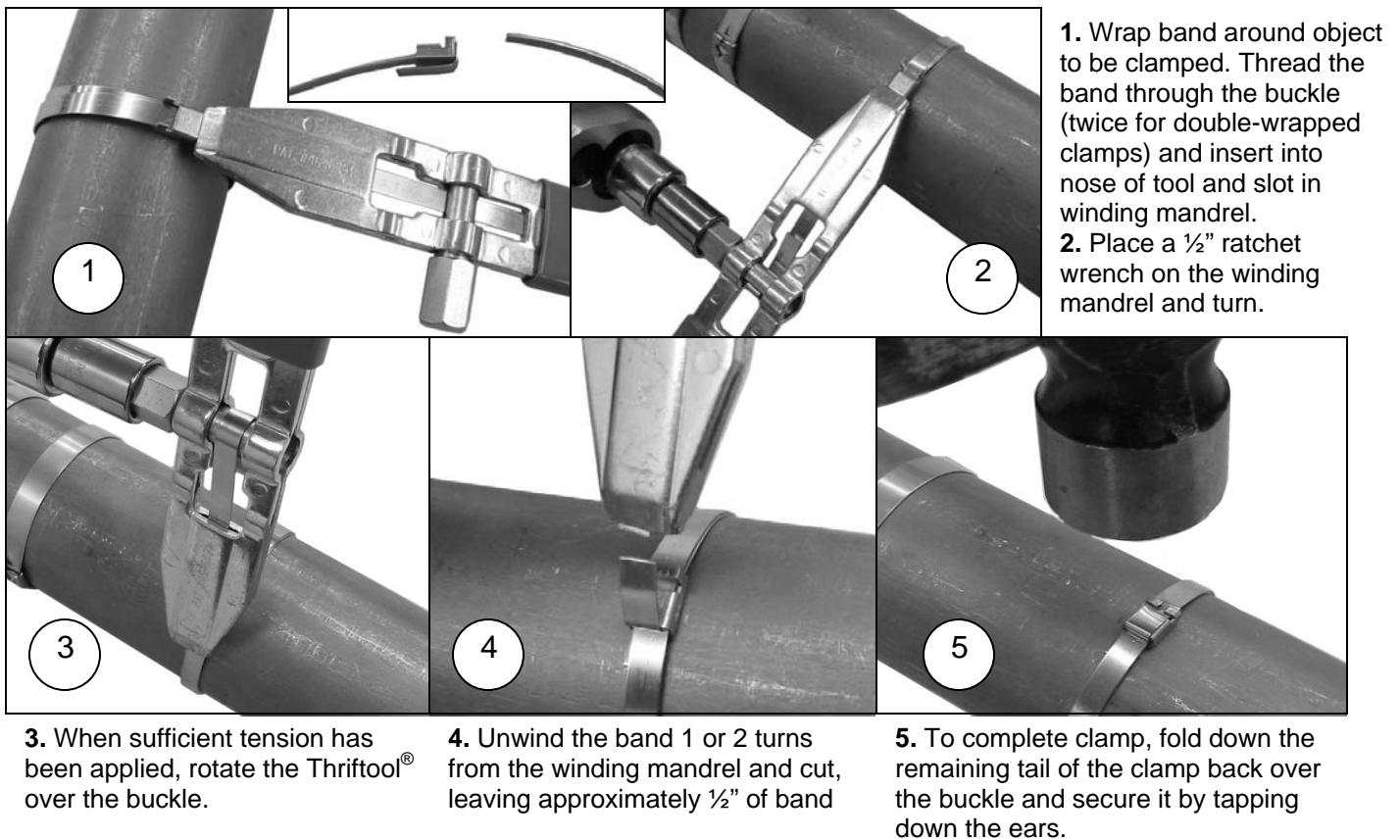

J07589/99
Thriftool®

For use with BAND-IT® free-end clamps, roll band and clips, JR. clamps, and SID clamps.

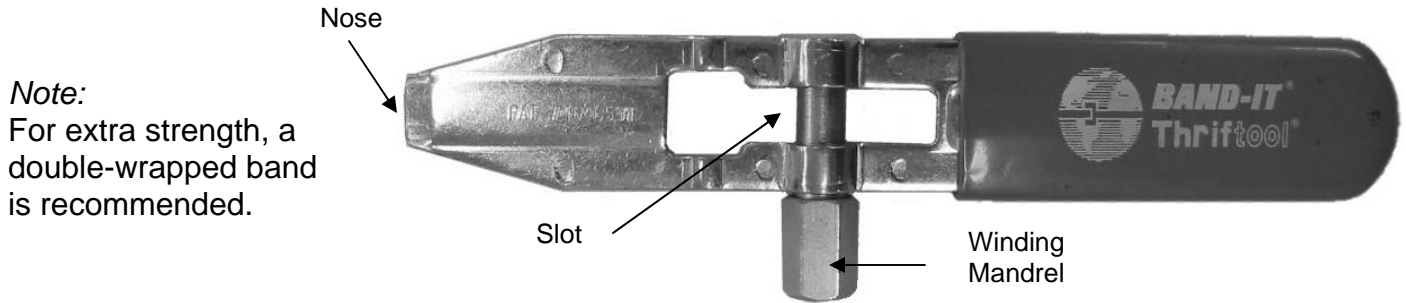

BAND-IT® JR and SID Clamps:

Follow the same procedure as described above with one exception: Cut off the tail as close to the buckle as possible. Tap down any remaining material.

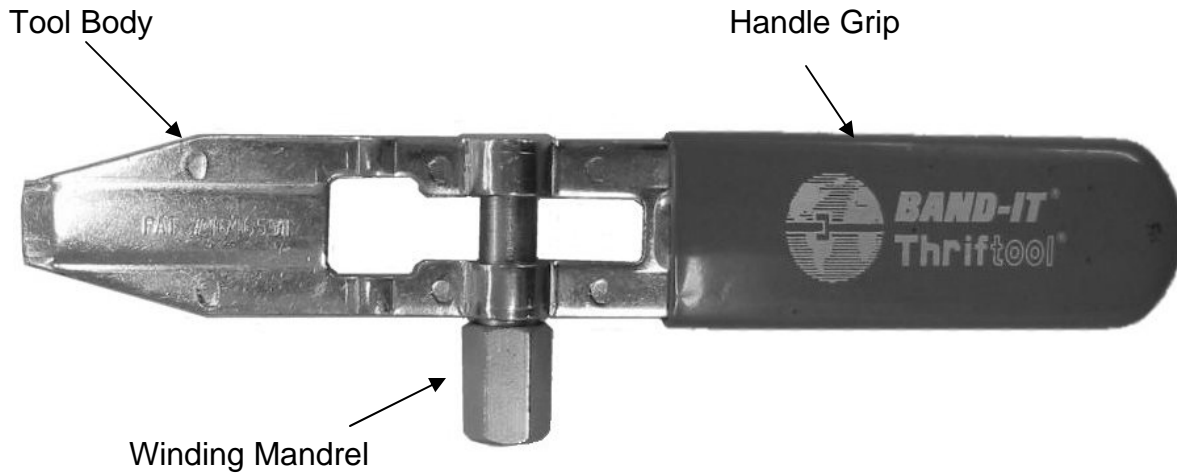

REPAIR PARTS LIST FOR J075	
PART #	DESCRIPTION
J07287	Winding mandrel, Thrifttool [®]
J07387	Grip, Handle, Thrifttool [®]
J07487	Tool body, Thrifttool [®]

Refer to website for warranty information: <http://www.band-it-idex.com/warranty.html>